



UF27B-LPD2

Undercounter 27" Low Profile
Freezer with Two Drawers



UF27B-LPD2
06/27/25
Item # 13721

W x D x H
27" x 30" x 31.9" *
*with 2.25" casters



Dimensions / Capacity

One-Section UF27B-LPD2

Interior Storage Capacity (CF) (AHAM)	6.21 ft ³
Overall Width x Depth (including 1" bumper)	27" x 30"
Height (including 2.25" casters)	31.9"
Drawer Opening Width x Depth	22.75" x 23"
Depth with Drawer Fully Open (including 1" bumper)	51"
Crated Weight	207 lbs.
Crated Length x Width x Height	34" x 31.5" x 35.5"

Electrical / Refrigeration

One-Section UF27B-LPD2

Voltage	115/60/1
HACR Breaker	15.0 Amps
Electrical Connection (NEMA)	5-15P ⚡
Voltage Range	104-126
Ambient Temp. Range	45° to 100°F
Control Setpoint Range	-12° to 11°F
Amperage	3
Energy Consumption (kWh/day) @ASHRAE	2.4
Heat Rejection (BTU/Hr.) @NSF	489
Approx. Nominal Compres. BTU/HR (HP)	1354(1/5HP)
Refrigerant / Charge Amount (oz)	R290 (1.9 oz)

Options

- | | |
|---------------------------------------------------------|-----------------------------------------------------------------------|
| <input type="checkbox"/> 4" Casters (HS-5035, set of 4) | <input type="checkbox"/> Overshelves (HS-5172 single) |
| <input type="checkbox"/> 6" Casters (HS-5036, set of 4) | <input type="checkbox"/> Overshelves (HS-5163 double) |
| <input type="checkbox"/> Drawer Liner (HS-5736, upper) | <input type="checkbox"/> Drawer divider bar (HS-4007, vertical) |
| <input type="checkbox"/> Drawer Liner (HS-5737, lower) | <input type="checkbox"/> Drawer divider bar (HS-5433 horizontal) |
| | <input type="checkbox"/> Stainless steel back panel (factory request) |



Seven year warranty
on labor, parts, and
compressor. Valid in
United States, Canada,
Puerto Rico and U.S.
Territories.

For more information, please visit
hoshizakiamerica.com/support/warranty/

Item #: _____
Project: _____
Qty: _____
AIA#: _____

Features

- Engineered to maintain NSF-7 temperatures in 100°F ambient.
- Stainless steel exterior front, sides and top with stainless steel interior sides, back, and floor
- Meets ADA requirements 
- Environmentally friendly R290 hydrocarbon refrigerant
- Cabinet and drawers are insulated with 2" CFC free, foamed in place polyurethane
- Drawer slides are constructed of 16 gauge stainless steel with acetal rollers
- Drawer frames are formed of 14 gauge stainless steel and securely fastened in the cabinet
- Top drawers will accommodate (1) 12 x 20 full size pan and (2) ¼ size pans. Bottom drawer will accommodate (1) full size pan.
- Top and bottom drawers allow for 6" deep pans
- Extruded aluminum flush mount drawer handle
- Magnetic drawer gasket is easily removable for cleaning
- Drawers have a 175 lb. dynamic load rating
- Hot gas condensate removal
- E-coated evaporator coil
- Standard with 2.25" casters (two with brakes)
- 10 ft. cord and plug

If GFCI is required, a GFCI breaker MUST be used in lieu of GFCI receptacle

Hoshizaki reserves the right to change specifications without notice.



UF27B-LPD2

Undercounter 27" Low Profile
Freezer with Two Drawers



UF27B-LPD2
06/27/25
Item # 13721

FRONT VIEW

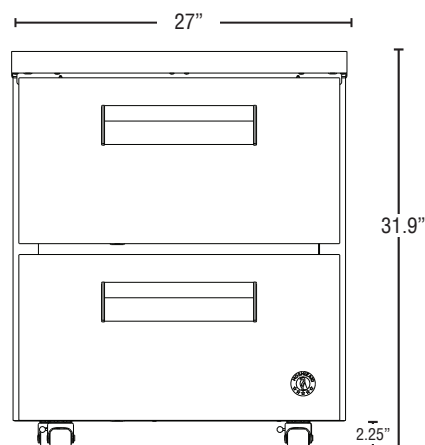

SIDE VIEW

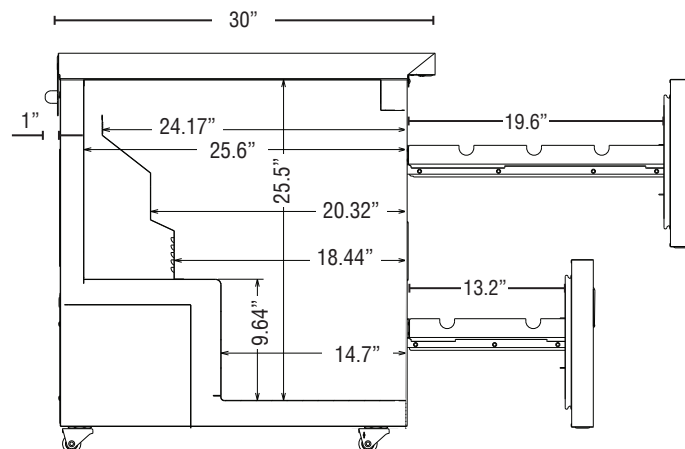

PLAN VIEW

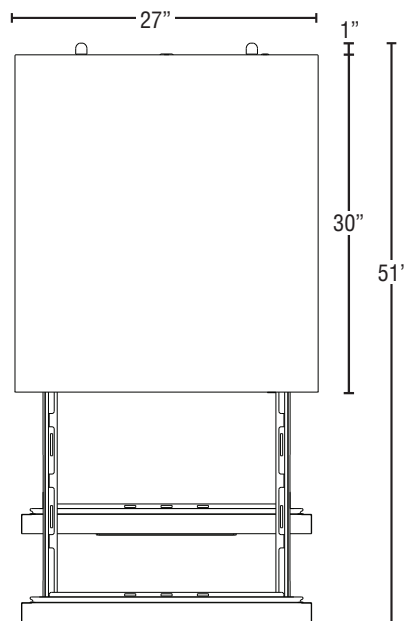

Cabinet Construction

The exterior cabinet top, front, and sides, are constructed of high quality stainless steel. The exterior back and bottom are constructed of coated steel. The cabinet interior features stainless steel back, sides, and floor with an ABS top. One heavy duty epoxy coated shelf per section is standard. Mounted on anodized aluminum pilasters the shelves are adjustable in $\frac{1}{2}$ " increments. Cabinet walls are insulated with 2" CFC free, foamed in place polyurethane. 2.25" polyolefin, stem casters (two with brakes) are standard.

Drawer Construction

Drawer fronts are constructed of high grade stainless steel inside and out and drawers are insulated with 2" free foamed in place polyurethane. The bottom drawers will accommodate 6" deep pans. Full size pans in the top drawer can be oriented longways from front to back. The top drawer will accommodate 4" deep pans with either orientation. The top drawer will also accommodate (1) $\frac{1}{2}$ size pan & (1) $\frac{1}{3}$ size pan 6" deep at the front of the drawer opening and provide capacity for (1) $\frac{1}{4}$ size pan and (1) $\frac{1}{6}$ size pan 4" deep in the rear of the drawer. HS-5432 is recommended for this configuration. Drawer frames are formed of 14 gauge stainless steel and securely fastened in the cabinet. The drawer slides are 16 gauge stainless steel with acetal rollers to prevent metal to metal contact between the drawer slides and reduce wear. The drawer slides have a dynamic load capacity of 175 lbs. and have been life tested (fully loaded) three hundred thousand openings and closings without showing significant wear. The flush mount handles are constructed of extruded aluminum. Snap-in magnetic drawer gaskets are durable and easily removed for cleaning.

Refrigeration System

The high efficiency refrigeration system is self-contained with an E-coated evaporator for extended life. Condensate removal is accomplished with an energy efficient non-electric evaporation system. A capillary tube controls the flow of environmentally friendly R290 refrigerant through the evaporator. Refrigeration system utilizes an "off cycle" defrost to eliminate any ice on the evaporator coil. 115 volt units are equipped with a ten foot cord and plug (20.0 amps or less).